

# TGM5

## series



### Product Segments

- **Care Motion**

TiMOTION's TGM5 series gear motor was designed primarily for medical applications, but can be used in a wide range of other applications that require a water resistant motion product. This economical, high torque product allows for fast, smooth and quiet adjustment of built-in spindles through the use of external limit switches. Shafting allows for the mechanical synchronization of dual spindles.

#### General Features

Max. rated torque	18.3Nm
Max. speed at max. load	88RPM (±5%)
Max. speed at no load	117RPM (±5%)
IP rating	IP66W
Certificate	UL962
Output signals	Hall sensors
Options	Motor brake
Voltage	12, 24, 36V DC or 24V /36V DC (Thermal switch)
Operational temperature range at full performance	+5°C~+45°C
Hexagon hole for the shaft by 12mm diameter	
Low noise	

## Drawing

Standard Dimensions  
(mm)

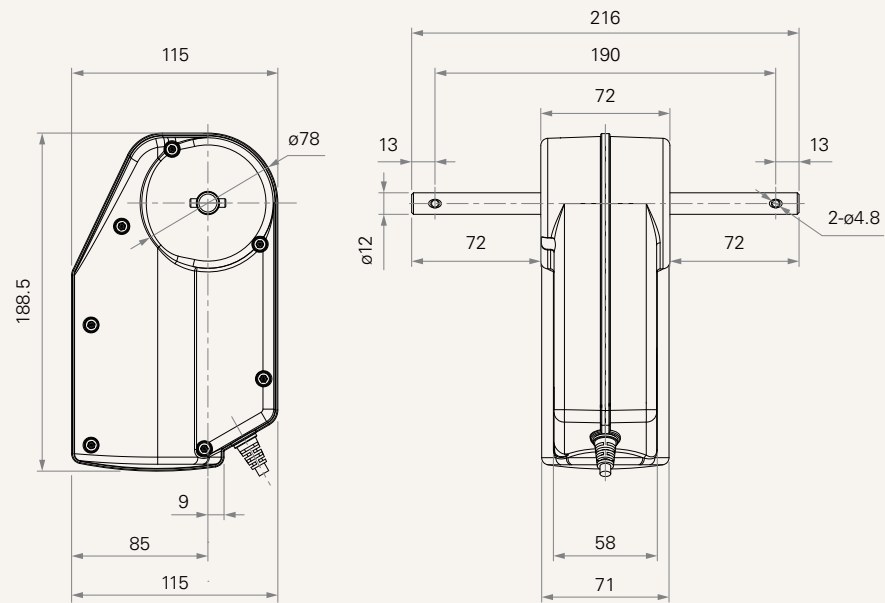

## Load and Speed

CODE	Torque Load (Nm)	Self locking force (Nm)		Typical Current (A)		Typical Speed (RPM, ±5%)		Hall Sensor Output		
		Brake		No Load 32V DC	With Load 24V DC	No Load 32V DC	With Load 24V DC	Magnet Poles	Period (ms)	
		#0	#M						No Load 32V DC	With load 24V DC
		Motor Speed (3800RPM)								
A	18.3	5	11	≤ 1.5	12.0	98~117	73~88	2	11.0~12.3	24.8~27.5

## Note

- Please refer to the approved drawing for the final authentic value.
- The current & speed in table and diagram are tested with TiMOTION control boxes, and there will be around 10% tolerance depending on different models of the control box. (Under no load condition, the voltage is around 32V DC. At rated load, the voltage output will be around 24V DC)

## Performance Data (24V DC Motor)

Motor Speed (3800RPM)

Speed vs. Torque Load

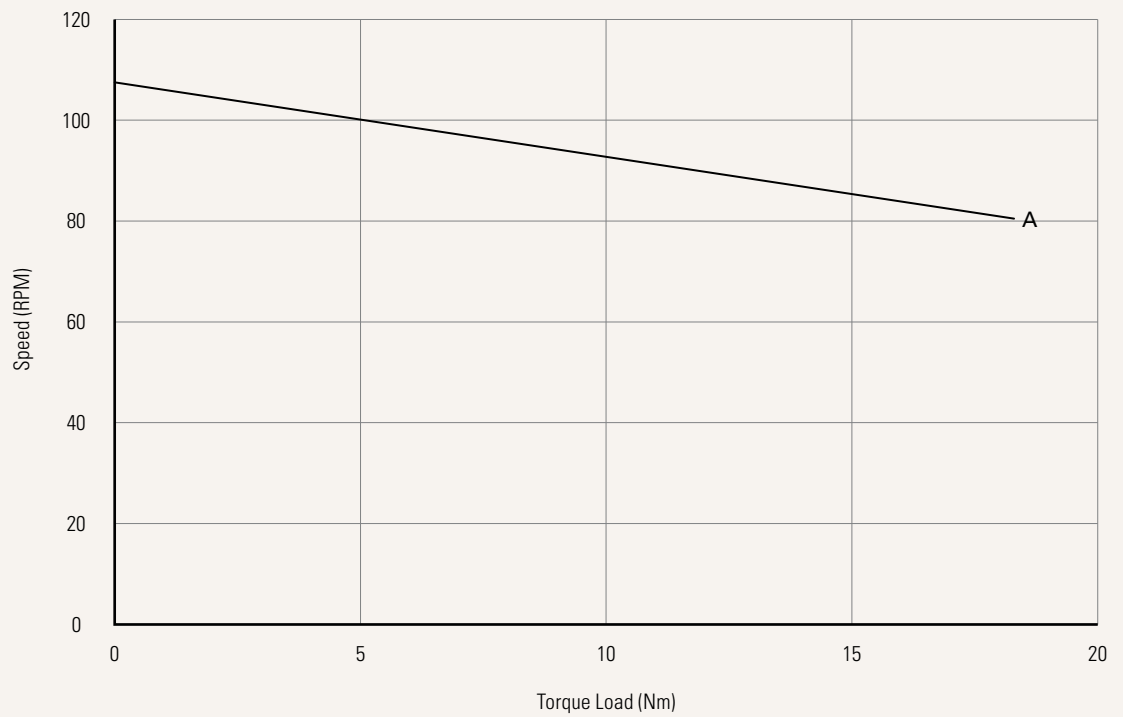

Current vs. Torque Load

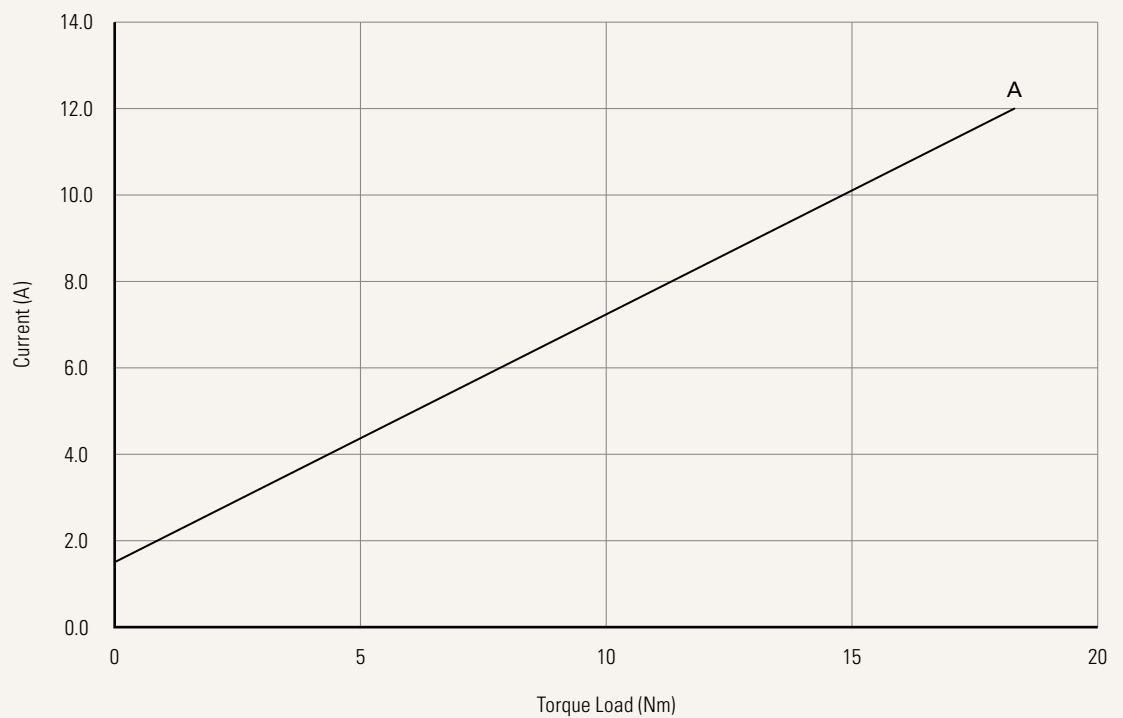

<b>Voltage</b>	1 = 12V DC	3 = 36V DC	7 = 36V DC, Thermal switch	
	2 = 24V DC	5 = 24V DC, Thermal switch		
<b>Load and Speed</b>	<a href="#">See page 2</a>			
<b>Output Signal</b>	0 = Without	2 = Hall sensor*2		
<b>Brake</b>	0 = Without	M = Motor brake		
<b>Motor Brake</b>	0 = Two way			
<b>Color</b>	1 = Black	2 = Pantone 428C		
<b>IP Rating</b>	1 = Without	2 = IP54	3 = IP66	5 = IP66W
<b>Connector</b> <a href="#">See page 5</a>	1 = DIN 6P, 90°	2 = Tinned leads	E = Molex 8P	
<b>Cable Length (mm)</b>	1 = Straight, 500 2 = Straight, 750	3 = Straight, 1000 4 = Straight, 1250	5 = Straight, 1500 6 = Straight, 2000	7 = Curly, 200 8 = Curly, 400
<b>Internal Limit Switch</b>	0 = Without	1 = With		
<b>Output Spindle Rotation Number</b>	00 = Without internal limit switch XX = With internal limit switch, number of output rotations (between25-58 rotations, factory preset)			

---

## Connector

1 = DIN 6P, 90°

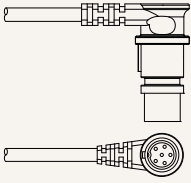

2 = Tinned leads

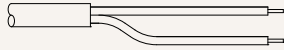

E = Molex 8P

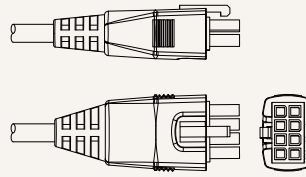

---

## Terms of Use

The user is responsible for determining the suitability of TiMOTION products for a specific application. TiMOTION products are subject to change without prior notice.